

表面涂层链条 Surface Coating Chains

镀锌链条 Zinc-Plated Chains

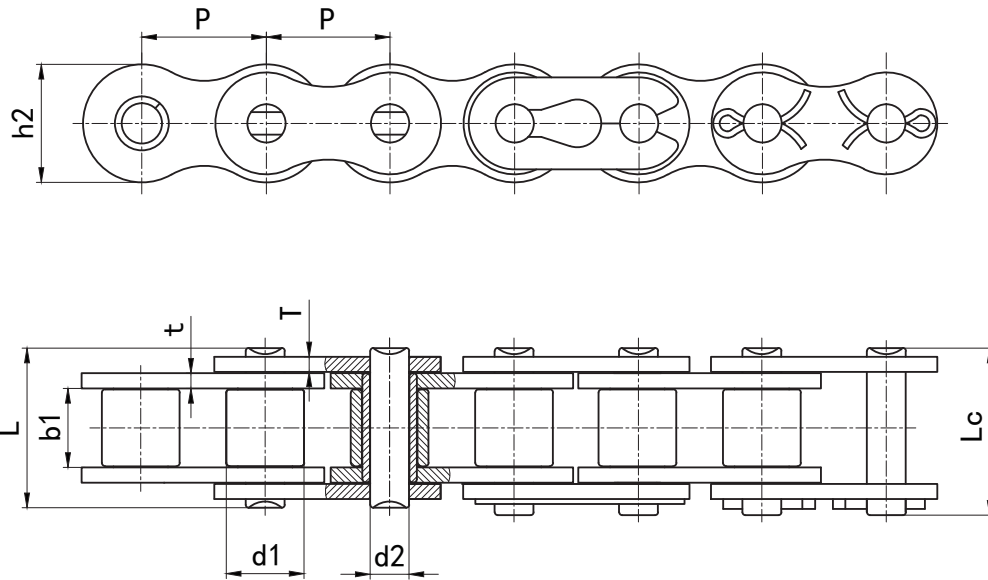

征和链号 CHOHO Chain No.	节距	滚子直径	内节内宽	销轴直径	销轴长度		内链板高度	链板厚度	抗拉强度	每米重量
	Pitch	Roller diameter	Width between inner plates	Pin diameter	Pin length		Inner plate depth	Plate thickness	Ultimate tensile strength	Weight per meter
	P mm	d1 max mm	b1 min mm	d2 max mm	L max mm	Lc max mm	h2 max mm	t/T max mm	Q min kN	q kg/m
41-ZP-1	12.700	7.77	6.25	3.60	13.7	15.5	9.91	1.20	6.7	0.40
40-ZP-1	12.700	7.92	7.85	3.98	16.7	18.3	12.07	1.50	14.1	0.65
50-ZP-1	15.875	10.16	9.40	5.09	20.7	23.8	15.09	2.00	22.2	1.03
60-ZP-1	19.050	11.91	12.57	5.96	26.2	28.3	18.10	2.42	31.5	1.51
80-ZP-1	25.400	15.88	15.75	7.94	32.9	36.4	24.13	3.10	56.7	2.61
100-ZP-1	31.750	19.05	18.90	9.54	40.8	44.1	30.17	4.00	88.5	3.90
120-ZP-1	38.100	22.23	25.22	11.11	50.8	54.7	36.20	4.80	127.0	5.60
140-ZP-1	44.450	25.40	25.22	12.71	54.7	61.0	42.23	5.60	173.0	7.52
160-ZP-1	50.800	28.58	31.55	14.29	65.5	70.0	48.26	6.40	227.0	10.08
08B-ZP-1	12.700	8.51	7.75	4.45	17.0	19.2	11.81	1.60	18.0	0.71
10B-ZP-1	15.875	10.16	9.65	5.08	19.6	22.3	14.73	1.70	22.4	0.93
12B-ZP-1	19.050	12.07	11.68	5.72	22.6	25.0	16.13	1.85	29.1	1.13
16B-ZP-1	25.400	15.88	17.02	8.28	36.1	39.2	21.08	4.0/3.0	60.0	2.72
20B-ZP-1	31.750	19.05	19.56	10.19	41.4	46.5	26.42	4.5/3.5	95.0	3.72
24B-ZP-1	38.100	25.40	25.40	14.63	53.4	59.9	33.40	6.0/4.8	160.0	7.10
28B-ZP-1	44.450	27.94	30.99	15.90	65.1	71.5	37.08	7.5/6.0	200.0	8.50
32B-ZP-1	50.800	29.21	30.99	17.81	66.8	72.5	42.29	7.0/6.0	250.0	10.25

输送带
Conveyor Chains

曳引链
Leaf Chains

传动链
Driving Chains

键槽和螺纹
Keyway And Thread

A系列滚子链轮
Sprocket - A-Series

B系列滚子链轮
Sprocket - B-Series

双节距链轮
Double Pitch Sprocket

双驱动链轮
Double-Drive Sprocket

同步带轮
Synchronous Pulley

■ 镀镍链条 Nickel-Plated Chains

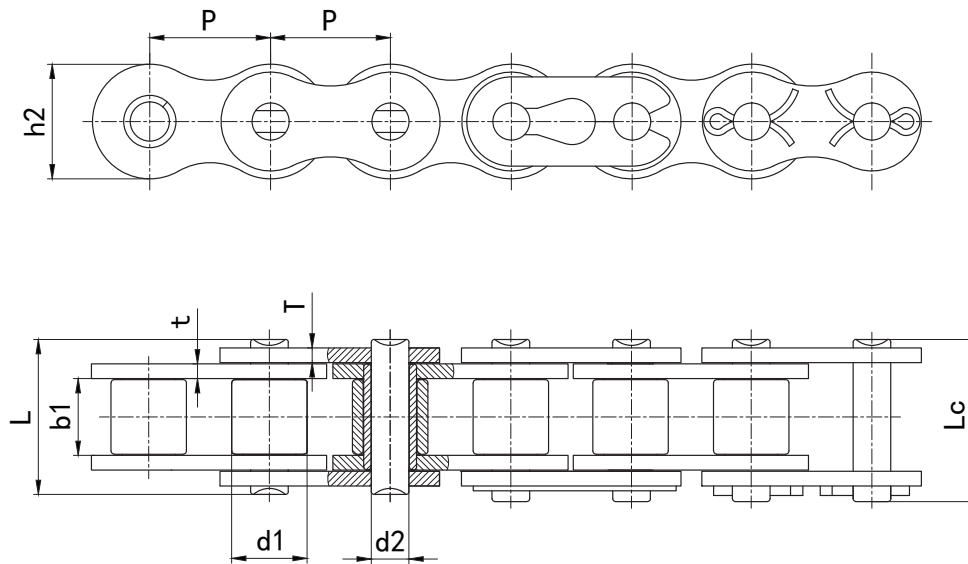

征和链号 CHOHO Chain No.	节距	滚子直径	内节内宽	销轴直径	销轴长度		内链板高度	链板厚度	抗拉强度	每米重量
	Pitch	Roller diameter	Width between inner plates	Pin diameter	Pin length		Inner plate depth	Plate thickness	Ultimate tensile strength	Weight per meter
	P	d1 max	b1 min	d2 max	L max	Lc max	h2 max	t/T max	Q min	q
	mm	mm	mm	mm	mm	mm	mm	mm	kN	kg/m
41-NP-1	12.700	7.77	6.25	3.60	13.7	15.5	9.91	1.20	6.7	0.40
40-NP-1	12.700	7.92	7.85	3.98	16.7	18.3	12.07	1.50	14.1	0.65
50-NP-1	15.875	10.16	9.40	5.09	20.7	23.8	15.09	2.00	22.2	1.03
60-NP-1	19.050	11.91	12.57	5.96	26.2	28.3	18.10	2.42	31.5	1.51
80-NP-1	25.400	15.88	15.75	7.94	32.9	36.4	24.13	3.10	56.7	2.61
100-NP-1	31.750	19.05	18.90	9.54	40.8	44.1	30.17	4.00	88.5	3.90
120-NP-1	38.100	22.23	25.22	11.11	50.8	54.7	36.20	4.80	127.0	5.60
140-NP-1	44.450	25.40	25.22	12.71	54.7	61.0	42.23	5.60	173.0	7.52
160-NP-1	50.800	28.58	31.55	14.29	65.5	70.0	48.26	6.40	227.0	10.08
08B-NP-1	12.700	8.51	7.75	4.45	17.0	19.2	11.81	1.60	18.0	0.71
10B-NP-1	15.875	10.16	9.65	5.08	19.6	22.3	14.73	1.70	22.4	0.93
12B-NP-1	19.050	12.07	11.68	5.72	22.6	25.0	16.13	1.85	29.1	1.13
16B-NP-1	25.400	15.88	17.02	8.28	36.1	39.2	21.08	4.0/3.0	60.0	2.72
20B-NP-1	31.750	19.05	19.56	10.19	41.4	46.5	26.42	4.5/3.5	95.0	3.72
24B-NP-1	38.100	25.40	25.40	14.63	53.4	59.9	33.40	6.0/4.8	160.0	7.10
28B-NP-1	44.450	27.94	30.99	15.90	65.1	71.5	37.08	7.5/6.0	200.0	8.50
32B-NP-1	50.800	29.21	30.99	17.81	66.8	72.5	42.29	7.0/6.0	250.0	10.25

输送机
Conveyor Chains

曳引链
Leaf Chains

传动链
Driving Chains

键槽和螺纹
Keyway And Thread

A系列滚子链轮
Sprocket - A Series

B系列滚子链轮
Sprocket - B Series

双节距链轮
Double Pitch Sprocket

双驱链轮
Double-Drive Sprocket

同步带轮
Synchronous Pulley

表面涂层链条 Surface Coating Chains

■ 镀达克罗链条 Dacromet Chain

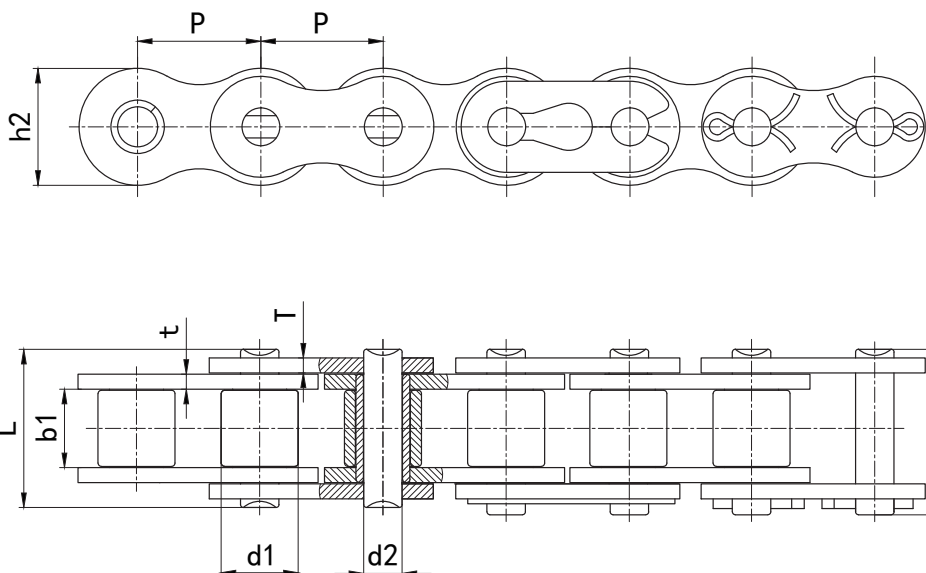

征和链号 CHOHO Chain No.	节距	滚子直径	内节内宽	销轴直径	销轴长度		内链板高度	链板厚度	抗拉强度	每米重量
	Pitch	Roller diameter	Width between inner plates	Pin diameter	Pin length		Inner plate depth	Plate thickness	Ultimate tensile strength	Weight per meter
	P mm	d1 max mm	b1 min mm	d2 max mm	L max mm	Lc max mm	h2 max mm	t/T max mm	Q min kN	q kg/m
41-DR-1	12.700	7.77	6.25	3.60	13.7	15.5	9.91	1.20	6.7	0.40
40-DR-1	12.700	7.92	7.85	3.98	16.7	18.3	12.07	1.50	14.1	0.65
50-DR-1	15.875	10.16	9.40	5.09	20.7	23.8	15.09	2.00	22.2	1.03
60-DR-1	19.050	11.91	12.57	5.96	26.2	28.3	18.10	2.42	31.5	1.51
80-DR-1	25.400	15.88	15.75	7.94	32.9	36.4	24.13	3.10	56.7	2.61
100-DR-1	31.750	19.05	18.90	9.54	40.8	44.1	30.17	4.00	88.5	3.90
120-DR-1	38.100	22.23	25.22	11.11	50.8	54.7	36.20	4.80	127.0	5.60
140-DR-1	44.450	25.40	25.22	12.71	54.7	61.0	42.23	5.60	173.0	7.52
160-DR-1	50.800	28.58	31.55	14.29	65.5	70.0	48.26	6.40	227.0	10.08
08B-DR-1	12.700	8.51	7.75	4.45	17.0	19.2	11.81	1.60	18.0	0.71
10B-DR-1	15.875	10.16	9.65	5.08	19.6	22.3	14.73	1.70	22.4	0.93
12B-DR-1	19.050	12.07	11.68	5.72	22.6	25.0	16.13	1.85	29.1	1.13
16B-DR-1	25.400	15.88	17.02	8.28	36.1	39.2	21.08	4.0/3.0	60.0	2.72
20B-DR-1	31.750	19.05	19.56	10.19	41.4	46.5	26.42	4.5/3.5	95.0	3.72
24B-DR-1	38.100	25.40	25.40	14.63	53.4	59.9	33.40	6.0/4.8	160.0	7.10
28B-DR-1	44.450	27.94	30.99	15.90	65.1	71.5	37.08	7.5/6.0	200.0	8.50
32B-DR-1	50.800	29.21	30.99	17.81	66.8	72.5	42.29	7.0/6.0	250.0	10.25

输送带
Conveyor Chains

曳引链
Leaf Chains

传动链
Driving Chains

键槽和螺纹
Keyway And Thread

A系列滚子链轮
Sprocket - A-Series

B系列滚子链轮
Sprocket - B-Series

双节距链轮
Double Pitch Sprocket

双驱动链轮
Double-Drive Sprocket

同步带轮
Synchronous Pulley

不锈钢链条 Stainless Steel Chains

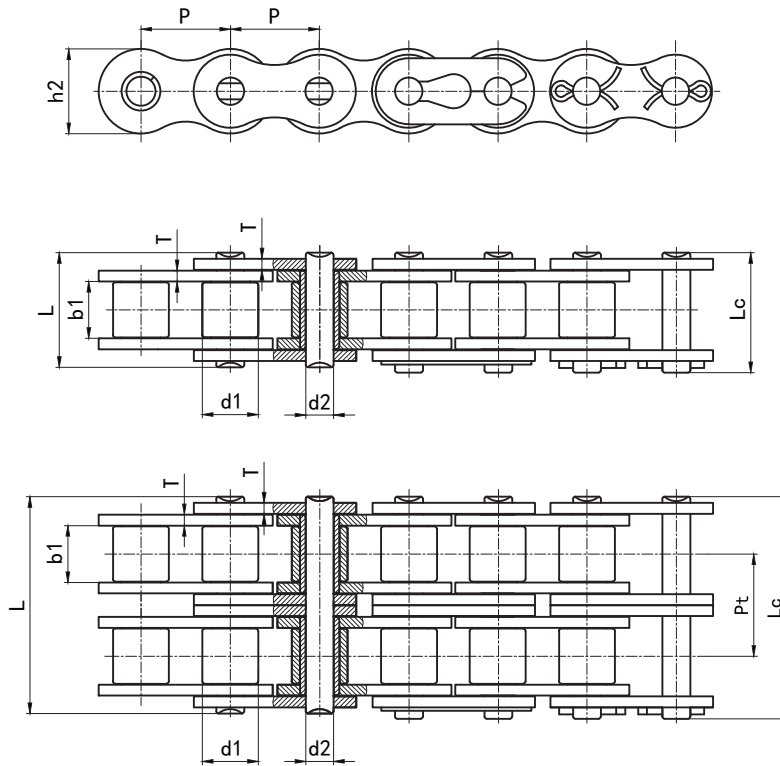

征和链号 CHOHO Chain No.	节距	滚子直径	内节内宽	销轴直径	销轴长度		内链板高度	链板厚度	排距	抗拉强度	每米重量
	Pitch	Roller diameter	Width between inner plates	Pin diameter	Pin length		Inner plate depth	Plate thickness	Transverse pitch	Ultimate tensile strength	Weight per meter
	p	d1 max	b1 min	d2 max	L max	Lc max	h2 max	T max	Pt	Q min	q
	mm	mm	mm	mm	mm	mm	mm	mm	mm	kN	kg/m
40-SS-1	12.700	7.92	7.85	3.98	16.7	18.3	12.00	1.50	/	9.6	0.62
50-SS-1	15.875	10.16	9.40	5.09	20.7	22.3	15.09	2.00	/	15.2	1.02
60-SS-1	19.050	11.91	12.57	5.96	26.2	28.3	18.10	2.42	/	21.7	1.50
80-SS-1	25.400	15.88	15.75	7.94	32.9	36.4	24.13	3.15	/	38.9	2.60
100-SS-1	31.750	19.05	18.90	9.54	40.8	44.1	30.17	4.00	/	60.0	3.90
120-SS-1	38.100	22.23	25.22	11.11	50.8	54.7	36.20	4.80	/	72.5	5.60
140-SS-1	44.450	25.40	25.22	12.71	54.7	61.0	42.23	5.60	/	94.0	7.50
160-SS-1	50.800	28.58	31.55	14.29	65.5	70.0	48.26	6.40	/	118.0	10.08
40-SS-2	12.700	7.92	7.85	3.98	31.2	33.3	12.00	1.50	14.38	16.7	1.12
50-SS-2	15.875	10.16	9.40	5.09	39.1	40.6	15.09	2.00	18.11	26.2	2.00
60-SS-2	19.050	11.91	12.57	5.96	49.1	50.8	18.10	2.42	22.78	37.7	2.92
80-SS-2	25.400	15.88	15.75	7.94	62.1	65.5	24.13	3.15	29.29	66.7	5.35
100-SS-2	31.750	19.05	18.90	9.54	76.6	80.5	30.17	4.00	35.76	123.9	7.80
120-SS-2	38.100	22.23	25.22	11.11	96.3	100.2	36.20	4.80	45.44	145.0	11.70
140-SS-2	44.450	25.40	25.22	12.71	103.6	110.1	42.23	5.60	48.87	188.0	15.14
160-SS-2	50.800	28.58	31.55	14.29	124.1	128.6	48.26	6.40	58.55	236.0	20.14

输送带
Conveyor Chains

曳引链
Leaf Chains

传动链
Driving Chains

键槽和螺纹
Keyway And Thread

A系列滚子链轮
Sprocket - A Series

B系列滚子链轮
Sprocket - B Series

双节距链轮
Double Pitch Sprocket

双驱链轮
Double-Drive Sprocket

同步带轮
Synchronous Pulley

不锈钢链条 Stainless Steel Chains

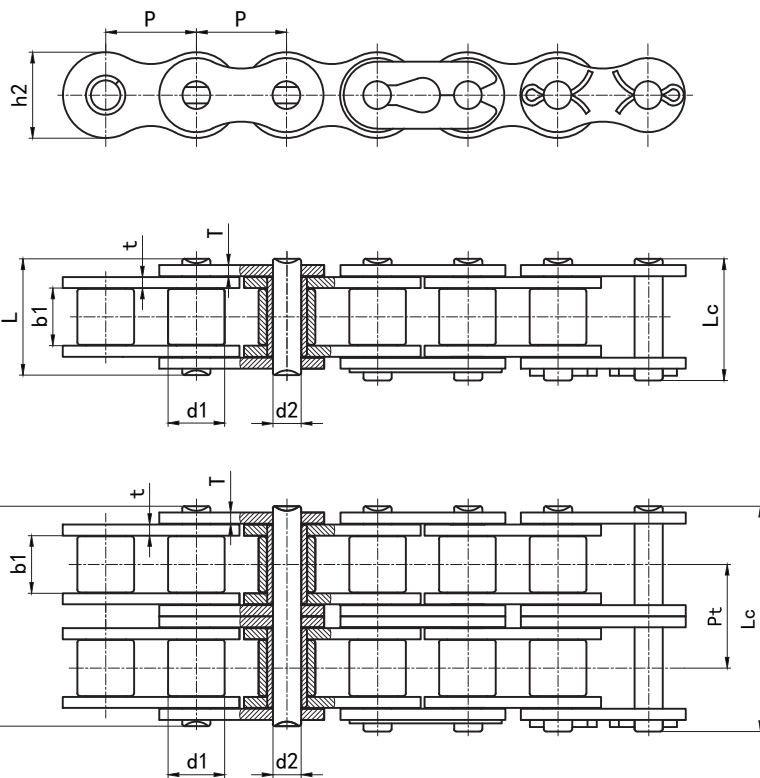

征和链号 CHOHO Chain No.	节距	滚子直径	内节内宽	销轴直径	销轴长度		内链板高度	链板厚度	排距	抗拉强度	每米重量
	Pitch	Roller diameter	Width between inner plates	Pin diameter	Pin length		Inner plate depth	Plate thickness	Transverse pitch	Ultimate tensile strength	Weight per meter
	p	d1 max	b1 min	d2 max	L max	Lc max	h2 max	t/T max	Pt	Q min	q
mm	mm	mm	mm	mm	mm	mm	mm	mm	mm	kN	kg/m
08B-SS-1	12.700	8.51	7.75	4.45	17.0	19.2	11.80	1.60	/	10.7	0.69
10B-SS-1	15.875	10.16	9.65	5.08	19.6	22.3	14.73	1.70	/	14.5	0.93
12B-SS-1	19.050	12.07	11.68	5.72	22.6	25.0	16.13	1.85	/	17.3	1.13
16B-SS-1	25.400	15.88	17.02	8.28	36.1	39.2	21.08	4.0/3.15	/	40.0	2.71
20B-SS-1	31.750	19.05	19.56	10.19	41.4	46.5	26.70	4.5/3.5	/	59.0	3.70
24B-SS-1	38.100	25.40	25.40	14.63	53.4	59.9	33.40	6.0/4.8	/	104.0	7.10
28B-SS-1	44.450	27.94	30.99	15.90	65.1	71.5	37.08	7.5/6.0	/	130.0	8.50
32B-SS-1	50.800	29.21	30.99	17.81	66.8	72.5	42.29	7.0/6.0	/	150.0	10.25
08B-SS-2	12.700	8.51	7.75	4.45	31.0	32.7	11.80	1.60	13.92	18.7	1.32
10B-SS-2	15.875	10.16	9.65	5.08	36.2	38.3	14.73	1.70	16.59	26.7	1.84
12B-SS-2	19.050	12.07	11.68	5.72	42.0	44.4	16.13	1.85	19.46	34.7	2.31
16B-SS-2	25.400	15.88	17.02	8.28	68.0	71.2	21.08	4.0/3.15	31.88	63.6	5.42
20B-SS-2	31.750	19.05	19.56	10.19	77.9	83.0	26.70	4.5/3.5	36.45	121.0	7.20
24B-SS-2	38.100	25.40	25.40	14.63	101.8	108.5	33.40	6.0/4.8	48.36	210.0	13.40
28B-SS-2	44.450	27.94	30.99	15.90	124.7	130.8	37.08	7.5/6.0	59.56	260.0	16.60
32B-SS-2	50.800	29.21	30.99	17.81	125.3	131.2	42.29	7.0/6.0	58.55	310.0	21.00

输送带
Conveyor Chains

曳引链
Leaf Chains

传动链
Driving Chains

键槽和螺纹
Keyway And Thread

A系列滚子链轮
Sprocket - A-Series

B系列滚子链轮
Sprocket - B-Series

双节距链轮
Double Pitch Sprocket

双驱动链轮
Double-Drive Sprocket

同步带轮
Synchronous Pulley