

倍速链 Accumulation Chains

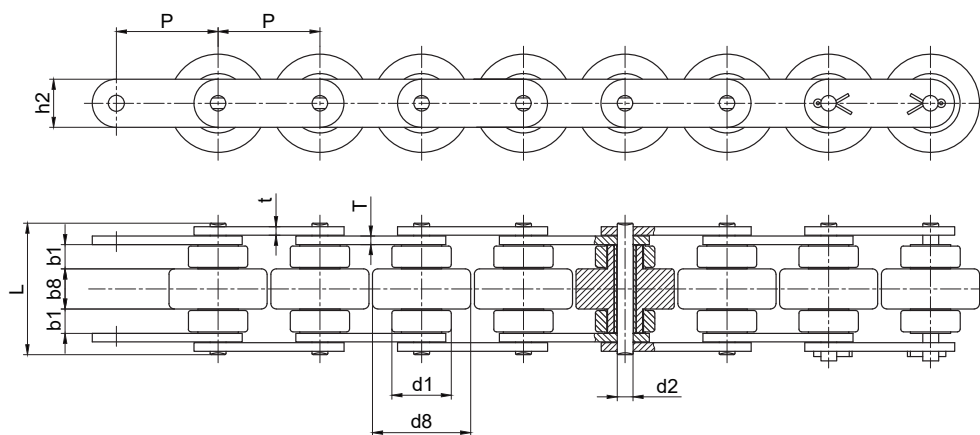

JB 链号 Chain No.	征和链号 CHOHO Chain No.	节距	滚子尺寸				销轴直径	销轴长度	链板尺寸		抗拉强度
		Pitch	Roller size				Pin diameter	Pin length	Attachment dimensions		Ultimate tensile strength
		p	d1 max	d8 max	b1 min	b8 max	d2 max	L max	h2 max	T/t max	Q min
		mm	mm	mm	mm	mm	mm	mm	mm	mm	kN
BS25-C206B	BS25-C206B	19.050	11.91	18.3	4.00	8.00	3.59	24.0	9.00	1.5/1.5	8.9
BS25-C208A	BS25-C2040	25.400	15.88	24.6	5.70	10.30	3.98	32.6	12.07	2.0/1.5	13.9
BS25-C210A	BS25-C2050	31.750	19.05	30.6	7.10	13.00	5.09	40.2	15.09	2.0/2.0	21.8
BS25-C212A	BS25-C2060	38.100	22.23	36.6	8.50	15.50	5.96	51.1	18.08	3.2/3.2	31.3
BS25-C216A	BS25-C2080	50.800	28.58	49.0	11.00	21.50	7.94	66.2	24.13	5.0/4.0	55.6
BS30-C206B	BS30-C206B	19.050	9.00	18.3	4.50	9.10	3.28	26.7	7.28	1.5/1.3	7.0
BS30-C208A	BS30-C2040	25.400	11.91	24.6	6.10	12.50	3.98	35.6	9.60	2.0/1.5	13.9
BS30-C210A	BS30-C2050	31.750	14.80	30.6	7.50	15.00	5.09	43.0	12.20	2.4/2.0	21.8
BS30-C212A	BS30-C2060	38.100	18.00	37.0	9.75	20.00	5.96	58.5	15.00	4.0/3.2	31.3
BS30-C216A	BS30-C2080	50.800	22.23	49.0	12.00	25.20	7.94	71.9	18.60	5.0/4.0	55.6

注：塑料滚子与金属滚子可选择。

Conveyor Chains

Leaf Chains

Driving Chains

Keyway And Thread

Sprocket - A Series

Sprocket - B Series

Double Pitch Sprocket

Double Drive Sprocket

Synchronous Pulley

带大滚轮输送链 Conveyor Chain With Large Rollers

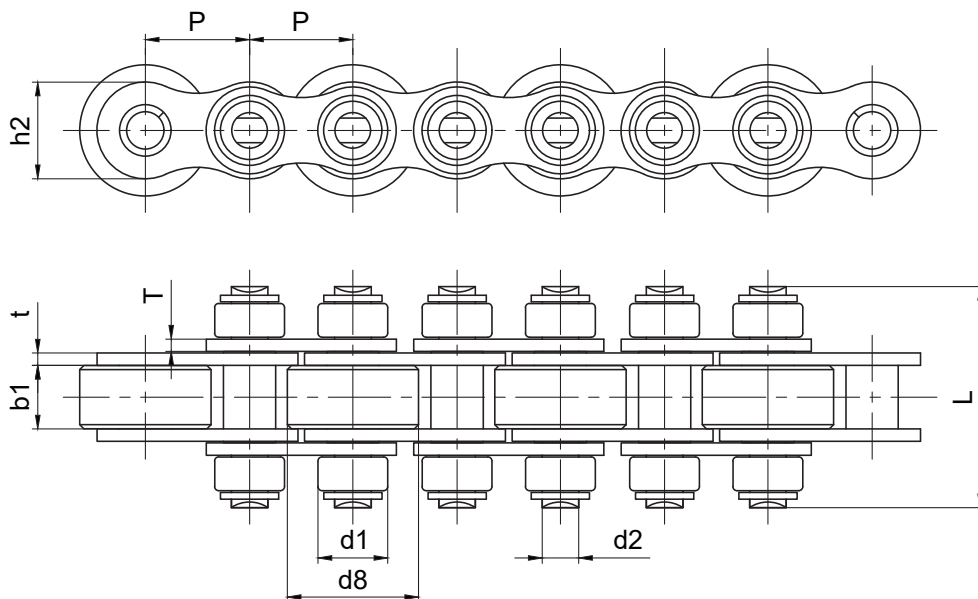

征和链号 CHOHO Chain No.	节距	滚子直径		内节内宽	销轴直径	销轴长度	链板尺寸		抗拉强度	平均抗拉强度
	Pitch	Roller diameter		Width between inner plates	Pin diameter	Pin length	Attachment dimensions		Ultimate tensile strength	Average tensile strength
	P	d1 max	d8 max	b1 min	d2 max	L max	h2 max	t/T max	Q min	Q ₀
	mm	mm	mm	mm	mm	mm	mm	mm	kN	kN
08BSF-C16/P16(27)	12.70	8.51	16.0	7.75	4.45	27.0	11.80	1.56	18.0	19.8
12BSF-C28/P28(42.9)	19.05	12.07	28.0	11.68	5.72	42.9	16.00	1.85	28.9	31.7
16BSF-C38.5/P38.5(65.5)	25.40	15.88	38.5	17.02	8.28	65.5	21.00	4.0/3.2	60.0	72.8

注：塑料滚子与金属滚子可替换。

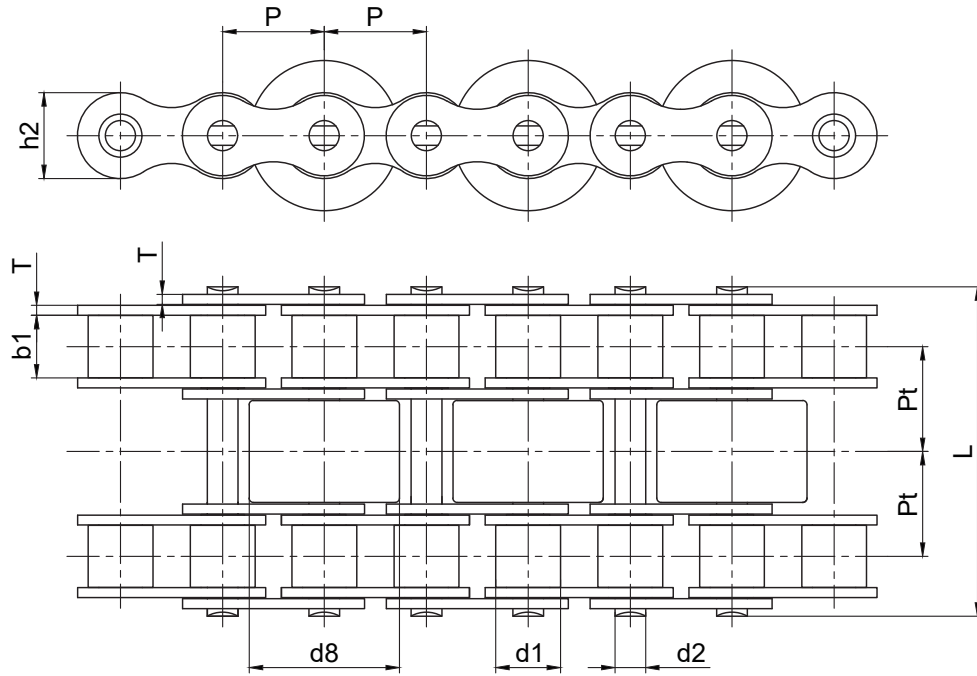

征和链号 CHOHO Chain No.	节距	滚子直径		内节内宽	销轴直径	销轴长度	链板尺寸		排距	抗拉强度	平均抗拉强度
	Pitch	Roller diameter		Width between inner plates	Pin diameter	Pin length	Attachment dimensions		Transverse pitch	Ultimate tensile strength	Average tensile strength
	P	d1 max	d8 max	b1 min	d2 max	L max	h2 max	T max	Pt	Q min	Q ₀
	mm	mm	mm	mm	mm	mm	mm	mm	mm	kN	kN
08BSF-C18(44.5)-3	12.700	8.51	18.00	7.75	4.45	44.5	11.8	1.60	13.92	32.0	38.7
12BSF-C28(61.3)-3	19.050	12.07	28.00	11.68	5.72	61.3	16.0	1.85	19.46	61.0	70.1

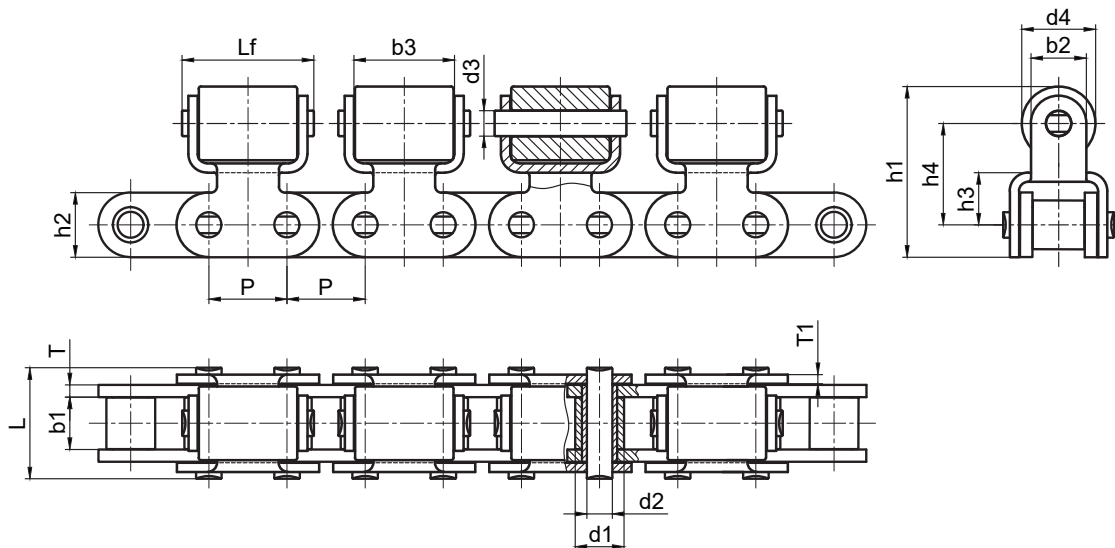

征和链号 CHOHO Chain No.	节距	滚子直径		销轴直径		内节内宽	销轴长度		链板尺寸		链板尺寸					抗拉强度	平均抗拉强度	
	Pitch	Roller diameter		Pin diameter		Width between inner plates	Pin length		Attachment dimensions		Attachment dimensions					Ultimate tensile strength	Average tensile strength	
	P	d1 max	d4 max	d2 max	d3 max	b1 min	L max	Lf max	h2 max	T max	b2	h1	h3	h4	b3 min	T1	Q min	Q ₀
	mm	mm	mm	mm	mm	mm	mm	mm	mm	mm	mm	mm	mm	mm	mm	mm	kN	kN
C16B-TR-SBR	25.400	15.88	24	8.28	8.28	17.02	35.9	42.8	21.0	4.0	18.0	55.5	17.0	33.0	32.5	3.0	60.0	72.5

输送带
Conveyor Chains

曳引链
Leaf Chains

传动链
Driving Chains

键槽和螺纹
Keyway And Thread

A系列滚子链轮
Sprocket - A-Series

B系列滚子链轮
Sprocket - B-Series

双节距链轮
Double Pitch Sprocket

双驱动链轮
Double-Drive Sprocket

同步带轮
Synchronous Pulley