



征和官方公众号



征和官网



征和官方抖音



# CHOHO

制造厂商：青岛征和工业股份有限公司  
地 址：中国青岛平度市香港路112号  
电 话：0532-88309788  
<http://www.chohogroup.com>

QINGDAO CHOHO INDUSTRIAL CO.,LTD.  
Add: No.112 Hongkong Road,Pingdu, Qingdao City, 266700 China.  
Tel / Fax: +86-532-83305910 E-mail:info@chohogroup.com  
<http://www.chohogroup.com>



Recycled Paper

本媒体包含的数据源自公司 2025年10月 资料，若有变动不再告之，请消费者谨慎参考。其中图片是本系列的部分产品，并不代表所有产品，所述产品的具体设计取决于制造商的要求和实际情况，因此可能会与本媒体中的描述有所出入。

Your sales representative

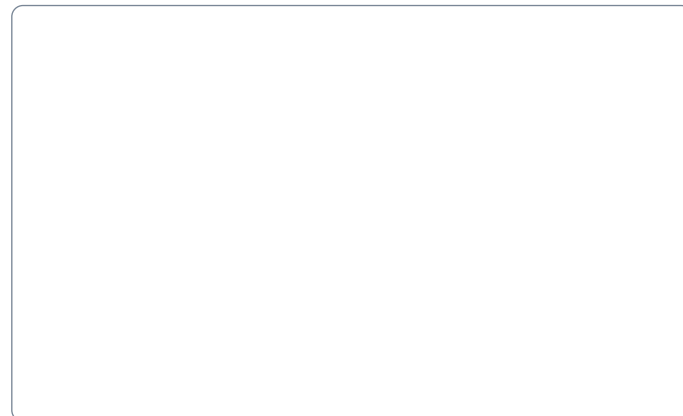

# CHOHO



## 物流运输链

# LOGISTICS TRANSPORT CHAIN



行业首家A股上市公司  
证券代码 003033

征和链系统技术领导者  
Choho,Chain Transmission Technology Leader



CHOHO



征和链系统技术领导者  
Choho, Chain Transmission Technology Leader

青島征和工業股份有限公司  
Qingdao CHOHO Industrial Co., Ltd

征和－链系统技术领导者

青島征和工業股份有限公司, 創立于 1987 年。創建以來, 公司從小到大, 從弱到強, 始終保持高速、健康的發展, 目前, 征和已成為中國鏈傳動行業首家 A 股上市公司、國家認定企業技術中心、國家技術創新示范企業、國家高新技術企業、國家製造業單項冠軍示范企業和國家工信部專精特新“小巨人”企業。在工業自動化鏈傳動系統、發動機鏈系統、車輛鏈條等領域, 征和已成為行業領軍企業。征和產品為昆船、新松、青島軟控、沈飛、信源、海爾、中通等上百家知名廠家配套; 車輛鏈系統已為本田、鈴木、雅馬哈、寶馬、大長江、比亞喬、本田技研、吉利、比亞迪、江鈴福特等五十多家企業提供產品和技術服務; 農機鏈系統為 CLAAS、雷沃、愛科、迪爾、巨明等行業知名廠家配套。

目前, 征和公司主導產品已達國際先進水平, 承擔多項國家級重大科研項目, 並制修訂了 24 項國家或行業標準, 獲得 300 余項國家發明和新型專利, 為行業的技術進步起到了引領和指導作用。

CHOHO, Chain Transmission Technology Leader

Qingdao CHOHO industrial co., LTD., is founded in 1987. Since its burn, the company from small to large, from weak to strong, always maintain high-speed, healthy development. At present, it has become the first A-share listed company in China chain drive industry, the national recognized enterprise technology center, national technology innovation demonstration enterprises, national high-tech enterprises, national manufacturing individual champion demonstration enterprise and the ministry of industry and information technology specializes in special new small giant enterprises. It has become the industry leader In industrial automation chain drive system, engine chain system, vehicle chain and other fields. CHOHO's products will support more than 100 well-known manufactures such as KESC, SIASUN, MESNAC, AVIC, SIWUN, Haier, ZTO and other industries; The vehicle chain system has provided products and technical services to more than 50 enterprises such as Honda, Suzuki, Yamaha, BMW, Dachangjiang, Piaggio, Honda technology research, Geely, BYD and JIANGling Ford; The agricultural chain system is supporting well-known manufactures in CLAAS, LOVOL, AGCO, DEERE, GIMIG and other industries.

Now, CHOHO's main product has reached international leading level. CHOHO is responsible for several national level important research and development projects, has amended 24 national or industrial standard and obtained more than 300 national invention as well as new modal patents, which performs a role of leading and instructing in the technology development of this industry.

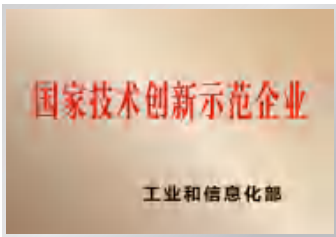

2017 年獲得行業首批國家技術創新示范企業  
2017 The first batch of National technology innovation demonstration enterprise



2020 年獲得國家專精特新“小巨人”企業  
2020 National specialized new "little Giant" enterprise

榮譽  
Honor

國家認定企業技術中心	National Certified Enterprise Technology Center
國家技術創新示范企業	National technology innovation demonstration enterprise
國家高新技術企業	State-level high-tech enterprise
國家製造業單項冠軍示范企業	National manufacturing individual champion demonstration enterprise
國家工信部專精特新“小巨人”企業	The ministry of industry and information technology specializes in special new small giant enterprises
CMCA 鏈傳動分會理事長單位	Chairman Unit of Chain Drive Branch of CMCA
國家綠色工廠	National Green Factory
國家卓越級智能工廠	National Intelligent Manufacturing Excellence Plant
國家博士后科研工作站	National Postdoctoral Research Station

1999 年, 通過法國 BVQI ISO9002 質量管理体系认证  
2003 年, 通過挪威 DNV ISO9001 质量体系认证  
2007 年, 通過 TS16949 质量管理体系认证  
2008 年, 通過 OHSAS18001 职业健康安全体系认证  
2008 年, 通過 ISO14001:2004 环境管理体系认证  
2009 年-2015 年, 通過德國 TUV 萊茵 ISO9001:2008 质量管理体系认证  
2009 年-2018 年, 通過德國 TUV 萊茵 TS16949:2009 质量管理体系认证  
2015 年, 通過青島世通 ISO9001:2008 质量管理体系认证  
2018 年, 通過青島世通 ISO9001:2015 质量管理体系认证  
2018 年, 通過德國 TUV 萊茵 IATF16949:2016 质量管理体系认证  
2018 年, 獲得 CNAS 實驗室認可证书  
2021 年, 通過德國 TUV 萊茵 ISO9001:2015 质量管理体系认证  
2022 年, 通過 ISO45001:2018 职业健康安全体系认证  
2022 年, 通過 ISO14001:2015 环境管理体系认证





# 侧弯链 SIDE BOW CHAIN



## INTRODUCE

侧弯链条通常用于物流输送系统,侧弯链条可以承受较大的载荷,适合长距离运输,输送形式有直线输送和曲线输送。

Side bow chain are usually used in logistics conveying systems, The side bow chain can bear a large load for long-distance transportation; The conveying form is straight and curved conveying.

## 行业应用 APPLICATION INDUSTRY



快递分拣 Express sorting



工业流水线 Industrial assembly line

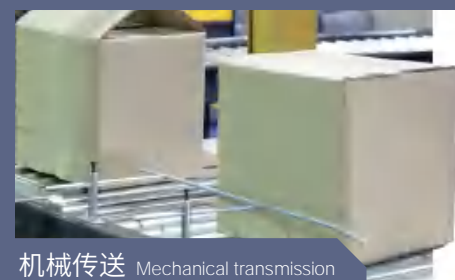

机械传送 Mechanical transmission

## 产品特点 FEATURES

CHOHO

### 滚子 Roller

无缝冷镦一体成型,具有极佳的抗冲击能力

Seamless cold heading integrated molding, with excellent impact resistance performance

### 内链板 Inner Plate

经过热处理和抛丸处理,提高了链条的拉力和疲劳性能

After heat treatment and shot blasting, the tensile and fatigue performance of the chain are improved

### 输送附板 Conveyor Attached Plate

一体折弯成型,具有极佳的尺寸一致性,保证输送过程稳定

Integrated bending forming, with excellent size consistency, ensuring stable conveying process

### 销轴 Pin

镀铬销轴,表面硬度 $\geq 850$  HV,可有效降低链条的磨损伸长率

Chrome plated pin, surface hardness  $\geq 850$  HV, can effectively reduce chain wear elongation

### 外链板 Outer Plate

经过热处理和抛丸处理,提高了链条的拉力和疲劳性能

After heat treatment and shot blasting, the tensile and fatigue performance of the chain are improved

### 套筒 Bush

异型套筒,可在链条侧弯运行时提供更大的接触面积来提高链条的耐磨性能

Special-shaped bush can provide greater contact area to improve the wear resistance of the chain when the chain is running in side bending

## 侧弯链 Side Bow Chain

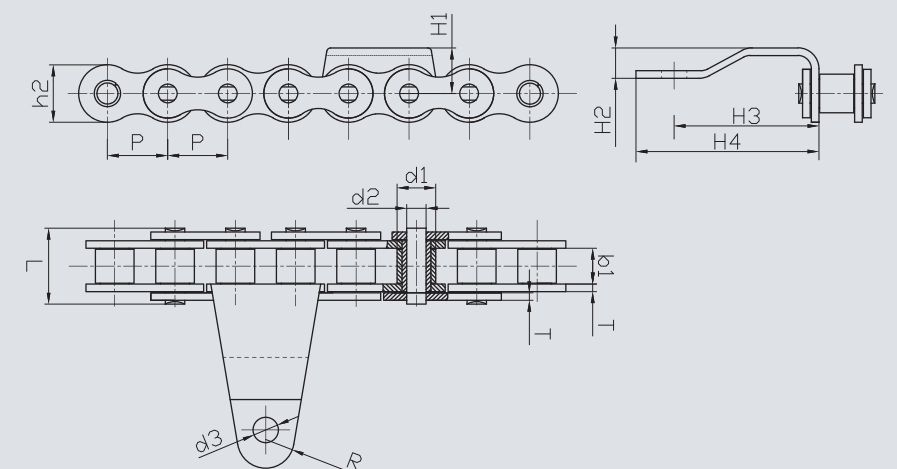



# 倍速链 ACCUMULATION CHAIN



## 产品特点 FEATURES

CHOHO

### • 滚子 Roller

选用优质中碳钢, 配合特殊热处理工艺, 具有极佳的承载能力

Selection of high quality medium carbon steel, with special heat treatment process, with excellent bearing capacity

### • 内链板 Inner Plate

经过热处理和抛丸处理, 提高了链条的拉力和疲劳性能

After heat treatment and shot blasting, the tensile and fatigue performance of the chain are improved

### • 销轴 Pin

采用化学热处理, 表面硬化层可增加链条的磨损寿命

Using chemical heat treatment, the surface hardening layer can increase the wear life of the chain

### • 外链板 Outer Plate

经过热处理和抛丸处理, 提高了链条的拉力和疲劳性能

After heat treatment and shot blasting, the tensile and fatigue performance of the chain are improved

### • 套筒 Bush

无缝冷镦一体成型, 特殊工艺处理, 提高链条磨损寿命

Seamless cold heading integrated molding, Special processing to improve the wear life of the chain

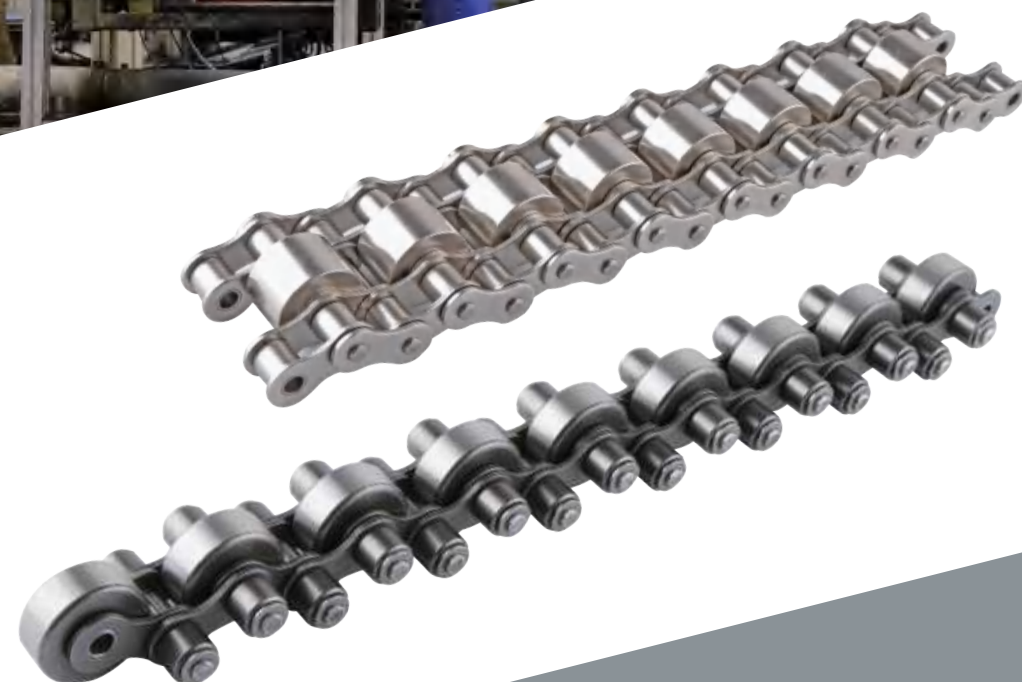
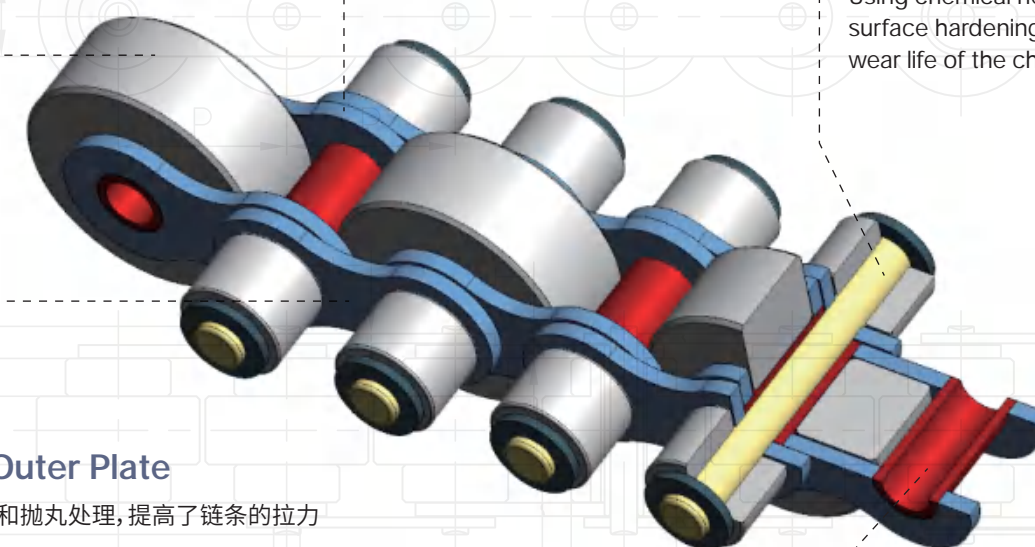

## INTRODUCE

倍速链除与链轮啮合的滚子外, 还有额外的钢制或塑料制滚子, 以在使用中起到输送作用。

Accumulation chain have extra bearing roller(steel or plastic) except for the rollers that mesh with the sprockets, in order to play the role of transport in use.

## 行业应用 APPLICATION INDUSTRY



家电生产线 Household appliance line



电子装配 Electronic product assembly



数码产品装配 Digital product assembly

## 倍速链 Accumulation Chains

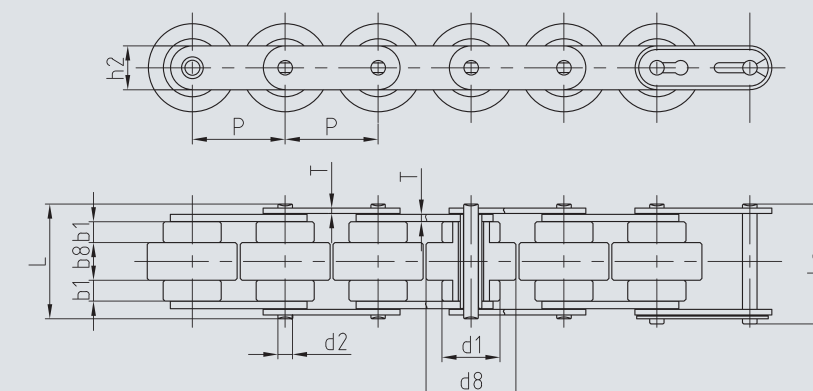



# 橡胶附板链 RUBBER ATTACHMENT PLATE CHAIN



## INTRODUCE

橡胶附板链是在标准滚子链基础加装橡胶附板的链条，母链符合ISO, ASME/ANSI, DIN, JIS等标准。

Rubber attached plate chain is a chain with rubber attached plate added to the base of standard roller chain. The chain conforms to ISO, ASME/ANSI, DIN, JIS and other standards.

## 行业应用 APPLICATION INDUSTRY

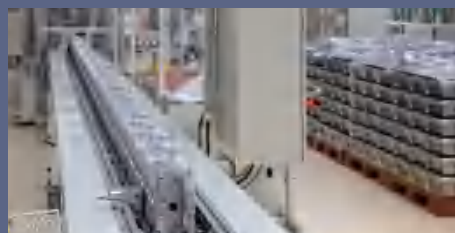

药品加工 Pharmaceutical processing



危险品加工 Dangerous goods processing



珠宝加工 Jewelry processing

## 产品特点 FEATURES

CHOHO

### 滚子 Roller

无缝冷镦一体成型，具有极佳的抗冲击能力

Seamless cold heading integrated molding, with excellent impact resistance performance

### 内链板 Inner Plate

经过热处理和抛丸处理，提高了链条的拉力和疲劳性能

After heat treatment and shot blasting, the tensile and fatigue performance of the chain are improved

### 橡胶附板

#### Rubber Attached Plate

硫化成型，尺寸一致性好，默认材质为 NBR75，也可根据需求定制

Vulcanized molding, size consistency is good, the default material is NBR75, can also be customized according to demand

### 销轴 Pin

采用化学热处理，表面硬化层可增加链条的磨损寿命

Using chemical heat treatment, the surface hardening layer can increase the wear life of the chain

### 外链板 Outer Plate

经过热处理和抛丸处理，提高了链条的拉力和疲劳性能

After heat treatment and shot blasting, the tensile and fatigue performance of the chain are improved

### 套筒 Bush

无缝冷镦一体成型，特殊工艺处理，提高链条磨损寿命

Seamless cold heading integrated molding, Special processing to improve the wear life of the chain

## 橡胶附板链 Conveyor Chains With Rubber Top

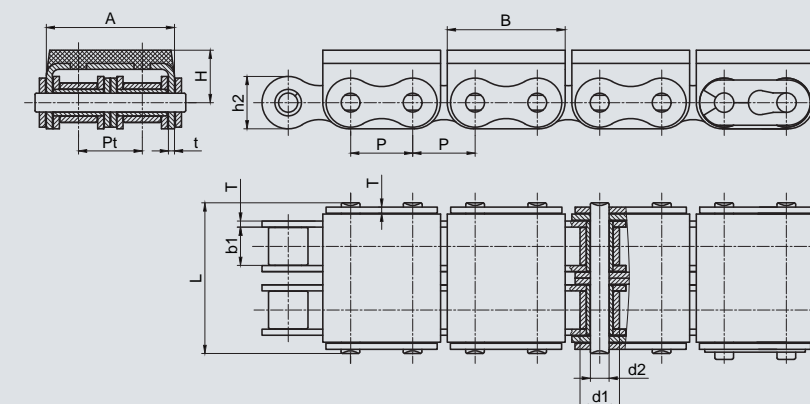



# 滚子链 FULL RANGE OF ROLLER CHAIN



## INTRODUCE

滚子链是最常见、用途最为广泛的一种输送链条，经过不段的技术创新与工艺改进，现已衍生出高耐磨、高强度、高疲劳、免维护、不锈钢以及不同表面处理等各种特性的升级产品。

Roller chain is the most common conveyor chain, after a period of technological innovation and process improvement, has been derived from various features of the upgraded products.

## 行业应用 APPLICATION INDUSTRY

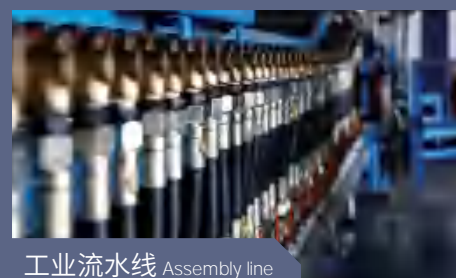

工业流水线 Assembly line



钢铁建筑业 Steel construction industry



印刷包装业 Printing and packaging industry

## 产品特点 FEATURES

CHOHO

另有直板输送链可选  
Straight conveyor chain is available

### 滚子 Roller

无缝冷镦一体成型，具有极佳的抗冲击能力

Seamless cold heading integrated molding, with excellent impact resistance performance

### 内链板 Inner Plate

经过热处理和抛丸处理，提高了链条的拉力和疲劳性能

After heat treatment and shot blasting, the tensile and fatigue performance of the chain are improved

### 销轴 Pin

采用化学热处理，表面硬化层可增加链条的磨损寿命

Using chemical heat treatment, the surface hardening layer can increase the wear life of the chain

### 外链板 Outer Plate

经过热处理和抛丸处理，提高了链条的拉力和疲劳性能

After heat treatment and shot blasting, the tensile and fatigue performance of the chain are improved

### 套筒 Bush

无缝冷镦一体成型，特殊工艺处理，提高链条磨损寿命

Seamless cold heading integrated molding, Special processing to improve the wear life of the chain

## A系列短节距精密滚子链 Short Pitch Precision Roller Chains (A series)

